

Main Drive, Kew
Stage 2 Tree Identification Table

Tree number	Removal proposed	Permit required under Heritage Act	Permit required under VPO2	Permit required under Clause 52.17	Native to Victoria	Species	Root preservation zone (metres) ¹	Diameter breast height (centimetres)	Condition (Good-G, Fair-F, Poor-P)	Worthiness of retention (1-10)	Plan grid reference
1	No	Yes	No	No	No	Schinus arera	6	80	G	7	M12
2	No	Yes	No	No	No	Cedrus deodara	5	54		7	M12
4A	Yes	No	No	No	No	Lagunaria patersonia		23	P	3	M11
4B	Yes	No	No	No	No	Arbutus unedo			P	2	M11
5	No	Yes	No	No	No	Cedrus deodara	6	65		7	M11
6	No	Yes	Yes	No	No	Quercus canariensis	6	78	G	7	M11
8	No	Yes	No	No	No	Cedrus deodara	4.5	52	G	7	L11
8A	No	Yes	No	No	No	Schinus arera	5	60	F/G	6	L11
10	No	Yes	Yes	No	No	Prunus ilicifolia	7	70	G	9	L11
13	No	Yes	No	No	No	Cedrus deodara	3.5	37	G	5	L11
14	No	Yes	Yes	No	No	Quercus canariensis	7	74	G	7	L11
18	No	Yes	Yes	No	No	Quercus canariensis	7	77	G	8	L11
20	No	Yes	Yes	No	No	Quercus canariensis	6	63	F	4	K11
21	No	No	No	Yes	No ²	Corymbia maculata	2	25	F/G	4	K11
24	No	Yes	Yes	No	No	Quercus canariensis	6	60	G	7	K11
25	No	Yes	Yes	No	No	Ulmus procera	6	65	G	7	K11
26	No	Yes	Yes	No	No	Ficus macrophylla	3	32	F	5	K11
27	No	Yes	Yes	No	No	Pinus canariensis	6	62	G	8	K11
28	No	Yes	Yes	No	No	Quercus canariensis	6	57	G	7	K11
29	No	Yes	Yes	No	No	Ulmus procera	6	83	F	7	K11
30	No	Yes	Yes	No	No	Quercus canariensis	7	75	G	8	K11
31	No	Yes	Yes	No	No	Ulmus procera	7	100	F/G	8	J11
32	No	Yes	Yes	No	No	Quercus canariensis	5	60	F	5	J11
33	No	Yes	Yes	No	No	Quercus canariensis	5	60	G	8	K11
34	No	Yes	Yes	No	No	Quercus canariensis	5	55	G	8	K11
35	No	Yes	Yes	No	No	Quercus canariensis	5	52	G	8	K11
35A	No	No	No	No ⁵	Yes	Eucalyptus leucocylon	2	18	F	4	K10
36	No	Yes	Yes	No	No	Ficus macrophylla	4	36	F	4	K11
37	No	Yes	Yes	No	No	Ficus macrophylla	4	44	F	5	JK11
38	No	Yes	Yes	No	No	Cupressus macrocarpa	8	120	P	1	J11
39	No	Yes	Yes	No	No	Quercus canariensis	6	65	G	8	J10/11
40	No	Yes	Yes	No	No	Ulmus procera	5	57	F	4	J11
41	No	Yes	Yes	No	No	Quercus robur	5	45	P	3	K10
42	Yes	Yes	No	No	No	Pinus radiata		120	P	2	K10
43	No	Yes	Yes	No	No	Quercus robur	4	48	P	4	K10
45	No	Yes	Yes	No	No	Quercus robur	5	58	G	7	J10
49	No	Yes	Yes	No	No	Ulmus procera	5.5	81	F/G	6	J11
50	No	Yes	Yes	No	No	Ulmus procera	6	66	F/G	7	J11
51	No	Yes	Yes	No	No	Quercus canariensis	6	66	F	6	J10
51A	No	Yes	Yes	No	No	Quercus canariensis	5	50	G	7	J10/11
52	No	Yes	Yes	No	No	Quercus canariensis	5	54	G	8	J10
52A	No	Yes	Yes	No	No	Cupressus torulosa	3.5	46	F	6	J11
53	No	Yes	Yes	No	No	Quercus canariensis	5.5	68	F/P	5	I10
53A	Yes	No	No	No	No	Leptospermum petersonii		12	P	2	J10
53B	Yes	No	No	No	No	Hakea suaveolens		20	F/P	2	J11
53C	Yes	No	No	No	No	Hakea suaveolens					IJ11
54	No	Yes	Yes	No	No	Ulmus procera	6	90	F/G	7	I11
55	No	Yes	Yes	No	No	Ulmus procera	5	62	F/G	7	I11
55A	Yes	Yes	Yes	No	No	Ficus macrophylla		28	F	4	I11
56	No	Yes	Yes	No	No	Quercus canariensis	5.5	66	G	7	I11
56A	No	Yes	Yes	No	No	Quercus canariensis	6	69	F/G	7	J11
57	No	Yes	Yes	No	No	Quercus canariensis	5	59	G	8	I11
58	No	Yes	Yes	No	No	Quercus canariensis	6	65	G	7	I11
59	No	Yes	Yes	No	No	Quercus canariensis	6	65	G	8	I11
60	No	Yes	Yes	No	No	Ulmus procera	6	85	F	7	I11
61	No	Yes	Yes	No	No	Quercus canariensis	6	80	F	6	I10
62	No	Yes	Yes	No	No	Ficus macrophylla	4	45	F/G	6	I10/11
63	No	Yes	Yes	No	No	Quercus canariensis	4.5	54	F/G	7	I10
64	No	No	No	No	No	Eucalyptus cladocalyx	6	80	F	5	I10
65	No	Yes	Yes	No	No	Cupressus torulosa	4	50	F/P	4	I10
66	No	Yes	Yes	No	No	Quercus canariensis	4.5	53	F	7	H10
67	No	No	Yes	No	No	Ulmus procera	3.5	39	F	5	I10
68	No	Yes	No	No	No	Pinus radiata	8	93	F	6	H10
69	No	No	Yes	No	No	Cupressus torulosa	4	47	F/G	7	H10
70	No	Yes	Yes	No	No	Quercus canariensis	5.5	65	F	7	H10
71	No	Yes	Yes	No	No	Quercus canariensis	6	62	P	2	H10
72	No	Yes	Yes	No	No	Ulmus procera	6	59	P	2	H10
73	No	Yes	Yes	No	No	Quercus canariensis	5	59	F/G	8	H10

YBuron →

YBuron permit required to remove under Heritage Act only.
Case permit required to remove under VPO2 and Heritage Act. These trees are the subject of Planning Permit Application 20070638.

- 1 Refer Stage 2 Tree Identification Plan.
- 2 A tree with a score of 1 has the lowest worthiness of retention while a tree with a score of 10 has the highest worthiness of retention.
- 3 Exempt from permit requirement under Clause 52.17-6 as tree within 10 metres of a building.
- 4 Exempt from permit requirement under Clause 52.17-6 as tree forms part of the minimum extent of native vegetation necessary for the construction, use and maintenance of a dwelling and buildings and works ancillary to a
- 5 Exempt from permit requirement under Clause 52.17-6 as tree has been planted for "street trees, gardens, horticultural purposes or the like".
- 6 Exempt from permit requirement under Clause 52.17-6 as tree is dead.

PLANNING and ENVIRONMENT ACT 1987 BOROONDARA PLANNING SCHEME	
PERMIT No. 2007 0638	
ENDORSED PLAN	
Sheet 1	of 1
Signed: _____ for	
MINISTER FOR PLANNING	
Date: 11 APR 2008	

Main Drive, Kew
Stage 2 Tree Identification Table

Tree number	Removal proposed	Permit required under Heritage Act	Permit required under VPO2	Permit required under Clause 52.17	Native to Victoria	Species	Root preservation zone (metres) ¹	Diameter breast height (centimetres)	Condition (Good-G : Fair-F : Poor-P)	Worthiness of retention (1-10)	Plan grid reference
74	No	Yes	Yes	No	No	Cupressus torulosa	4	41	FIG	7	H10
75	No	Yes	Yes	No	No	Quercus canariensis	6	64	FIG	7	H10
76	No	Yes	Yes	No	No	Quercus canariensis	5	50	FIG	7	G10
78	No	Yes	Yes	No	No	Cupressus torulosa	4	44	FIG	7	G10
79	No	Yes	Yes	No	No	Quercus canariensis	6	70	G	8	G10
80	No	Yes	Yes	No	No	Cupressus torulosa	4	38	FIG	7	G10
82	No	Yes	Yes	No	No	Ulmus procera	5.5	84	F	7	H11
84	No	Yes	Yes	No	No	Quercus canariensis	6.5	78	G	8	H11
85	No	Yes	Yes	No	No	Quercus canariensis	4.5	53	F	7	H11
86	No	Yes	Yes	No	No	Quercus canariensis	5.5	68	FIG	8	H11
87	No	Yes	Yes	No	No	Quercus canariensis	6	72	F	5	H11
88	No	Yes	Yes	No	No	Ulmus procera	5.5	81	F	7	H11
89	No	Yes	Yes	No	No	Ulmus procera	5.5	75	F	7	H11
90	No	Yes	Yes	No	No	Ulmus procera	5.5	76	F	7	G11
91	No	Yes	Yes	No	No	Quercus canariensis	5.5	64	G	8	G11
92	No	Yes	Yes	No	No	Quercus canariensis	6	85	G	8	G11
93	No	Yes	Yes	No	No	Quercus canariensis	4.5	56	F	6	G11
94	No	Yes	Yes	No	No	Ulmus procera	5	72	F	5	G11
95	No	Yes	Yes	No	No	Quercus canariensis	5	66	FIG	7	G11
96	No	Yes	Yes	No	No	Quercus canariensis	6	74	F	7	F11
97	No	Yes	Yes	No	No	Quercus canariensis	6	80	F	8	F11
98	No	Yes	Yes	No	No	Ulmus procera	5	87	F	6	F11/10
99	No	Yes	Yes	No	No	Quercus canariensis	6.5	93	G	8	F11
101	No	Yes	Yes	No	No	Ulmus procera	6.5	75	F	6	F10
103	No	Yes	Yes	No	No	Ulmus procera	3.5	44	P	3	F10
127	No	Yes	Yes	No	No	Cupressus torulosa	3	41	FIG	7	F10
128	No	No	No	No	No	Grevillea robusta	3	30	P	3	G10
133	No	Yes	Yes	No	No	Ficus macrophylla	2.5	29	F	5	F10
134	No	Yes	Yes	No	No	Cupressus macrocarpa	8	120	F/P	3	F10
134B	No	Yes	Yes	No	No	Quercus canariensis	4	52	P	2	F10
134C	No	No	No	No	No	Grevillea robusta	2.3	25	F/P	3	F10
136	No	Yes	Yes	No	No	Quercus canariensis	6	70	FIG	8	E10
136A	No	Yes	Yes	No	No	Quercus canariensis	3	32	P	2	F10
289	No	Yes	Yes	No	No	Quercus canariensis	4	54	F/P	4	H8
291	No	Yes	Yes	No	No	Quercus canariensis	5.5	66	FIG	7	H8
292	Yes	Yes	Yes	No	No	Quercus robur		48	P	1	H8
294	No	Yes	Yes	No	No	Quercus canariensis	6	67	G	7	H8
299	No	Yes	Yes	No	No	Quercus robur	4	52	F	5	H9
301	No	Yes	Yes	No	No	Quercus canariensis	6	73	F	7	J9
302	No	Yes	Yes	No	No	Quercus canariensis	5	60	F	7	J9
323	Yes	No	No	No ^{3,4,5}	Yes	Lepidospermum laevigatum		27	P	3	G8
324	Yes	No	No	No	No	Fraxinus angustifolia		43	F/P	3	G9
325	Yes	No	No	No	No	Fraxinus angustifolia		43	P	2	G9
326	Yes	No	No	No ^{3,4,5}	Yes	Eucalyptus maculata		25	P	2	G9
327	Yes	No	No	No ^{3,4,5}	Yes	Eucalyptus maculata		49	FIG	6	G9
328	Yes	No	No	No	No	Fraxinus angustifolia		32	F/P	3	G9
329	Yes	No	No	No	No	Fraxinus angustifolia		39	P	2	G9
330	No	Yes	No	No	No	Cupressus macrocarpa	6	90	F	5	H9
331	Yes	Yes	No	No	No	Pinus radiata		60	P	2	H9
332	No	No	No	No	No	Angophora costata	2.5	28	G	5	H9
332A	Yes	No	No	No	No	Liquidambar styraciflora		46	P	2	G9
333	Yes	No	No	No	No	Casuarina cunninghamii		70	F	4	H9
334	No	No	No	No	No	Casuarina glauca	2.7	5	G	5	H9
335	Yes	No	No	No ^{3,4,5}	Yes	Allocasuarina littoralis		35	G	5	H9
336A	Yes	No	No	No ^{4,5}	Yes	Eucalyptus globulus		100	P	2	H8
336B	Yes	No	No	No ^{4,5}	Yes	Eucalyptus globulus		62	P	2	H8
336C	Yes	No	No	No ^{4,5,6}	Yes	Eucalyptus globulus					H8
337	No	No	No	No	No	Lophostemon confertus	3	33	F	5	H8
338	Yes	No	No	No	No	Lophostemon confertus		37	P	2	H8/9
339	Yes	No	No	No ^{4,5}	Yes	Eucalyptus kintsoniana		31	P	3	H7
340	Yes	No	No	No ^{3,4,5}	Yes	Eucalyptus globulus		100	P	2	H7
341	Yes	No	No	No ⁶	Yes	Eucalyptus goniocalyx		32	F	5	H7
342	Yes	No	No	No	No	Fraxinus angustifolia		20	F/P	3	H7
343	Yes	No	No	No	No	Fraxinus angustifolia		26	F	3	H7
344A	Yes	No	No	No ^{3,5}	Yes	Brachycton populneum		32	F	4	G7
382	Yes	No	No	No	No	Melaleuca quinquenervia		25	F	4	G8
383	Yes	No	No	No	No	Casuarina glauca		48	FIG	5	FIG8
384	Yes	No	No	No	No	Casuarina glauca		26	F/P	3	F8
412	No	No	No	No ^{3,5}	Yes	Acmena smithii	4.5	55	G	6	F9
413	Yes	No	No	No	No	Lagunaria patersonii		26	F	5	F9
414	No	No	No	No ^{3,5}	Yes	Eucalyptus maculata	4.5	56	G	6	F9
415	Yes	No	No	No ^{3,5}	Yes	Eucalyptus maculata		53	FIG	6	F9

Garra

Yield Permit required to remove under Heritage Act only.
Enthal Permit required to remove under VPO2 and Heritage Act. These trees are the subject of Planning Permit Application 20070638.

1 Refer Stage 2 Tree Identification Plan.
2 A tree with a score of 1 has the lowest worthiness of retention while a tree with a score of 10 has the highest worthiness of retention.
3 Exempt from permit requirement under Clause 52.17-6 as tree within 10 metres of a building.
4 Exempt from permit requirement under Clause 52.17-6 as tree forms part of the minimum extent of native vegetation necessary for the construction, use and maintenance of a dwelling and buildings and works ancillary to a
5 Exempt from permit requirement under Clause 52.17-6 as tree has been planted for "street trees, gardens, horticultural purposes or the like".
6 Exempt from permit requirement under Clause 52.17-6 as tree is dead.

Main Drive, Kew
Stage 2 Tree Identification Table

Tree number	Removal proposed	Permit required under Heritage Act	Permit required under VPO2	Permit required under Clause 52.17	Native to Victoria	Species	Root preservation zone (metres)	Diameter breast height (centimetres)	Condition (Good-G; Fair-F; Poor-P)	Worthiness of retention (1-10)	Plan grid reference
416	Yes	No	No	No	No	<i>Salix chitensis</i>		35	F	4	F8
417	Yes	No	No	No	No	<i>Leptospermum patersoni</i>		45	F/P	3	F9
418	No	Yes	Yes	No	No	<i>Ficus macrophylla</i>	4.5	50	P	3	E10
619	No	No	No	No ⁵	Yes	<i>Eucalyptus balfourii</i>	6	75	P	2	M10
757	Yes	No	No	No ^{3,5}	Yes	<i>Callitris rhomboides</i>		Multi-stemmed	P	2	I10
757A	Yes	No	No	No ^{3,5}	Yes	<i>Eucalyptus pauciflora</i>		21	P	3	I10
758A	Yes	No	No	No ^{3,4,5,8}	Yes	<i>Acacia melanoxylon</i>					J10
758B	Yes	No	No	No ^{4,5}	Yes	<i>Acacia melanoxylon</i>		30	P	2	J10/9
758C	Yes	No	No	No ^{3,4,5}	Yes	<i>Acacia melanoxylon</i>		29	P	2	J10
759	Yes	No	No	No ⁵	Yes	<i>Acacia melanoxylon</i>		26	P	2	J9
760	No	No	No	No ⁵	Yes	<i>Eucalyptus camaldulensis</i>	2.5	33	F	4	J9
761	Yes	No	No	No ⁵	Yes	<i>Acacia melanoxylon</i>		23	P	2	J9
762	Yes	No	No	No ^{4,5}	Yes	<i>Eucalyptus leucorhylon</i>		38	F/P	5	I9
763	Yes	No	No	No ^{4,5}	Yes	<i>Eucalyptus meliodora</i>		26	P	2	I9
765	Yes	No	No	No	No	<i>Eucalyptus conferruminata</i>		26	P	2	I9
766	Yes	No	No	No	No	<i>Eucalyptus conferruminata</i>		30	P	3	I9
767	Yes	No	No	No	No	<i>Lophostemon confertus</i>		29	G	5	I8
768	Yes	No	No	No	No	<i>Lophostemon confertus</i>		30	G	5	H9
769	Yes	No	No	No	No	<i>Lophostemon confertus</i>		27	F	4	I9
770	No	No	No	No ⁵	Yes	<i>Eucalyptus camaldulensis</i>	2	31	F	4	I9
771	No	No	No	No	No	<i>Fraxinus angustifolia</i>	3	39	G	5	H9
772	Yes	No	No	No	No	<i>Fraxinus americana</i>		25	F	4	I9
773	No	No	No	No	No	<i>Piptarctus acerifolia</i>	4	47	F	5	H9
776A	No	No	No	No ^{3,5}	Yes	<i>Eucalyptus maculata</i>	3.5	43	F	4	G10
776B	No	No	No	No ^{3,5}	Yes	<i>Eucalyptus maculata</i>	1.5	18	F/P	3	G10
776C	Yes	No	No	No ^{4,5}	Yes	<i>Eucalyptus maculata</i>		38	F/P	3	H10
777	Yes	No	No	No	No	<i>Melaleuca styphelioides</i>		51	P	2	G10
778	No	No	No	No	No	<i>Fraxinus angustifolia</i>	3	47	G	6	G9
779	Yes	No	No	No	No	<i>Leptospermum patersoni</i>		41	F/P	4	G9/10
822	Yes	No	No	No	No	<i>Calodendrum capense</i>		12	F/P	3	J10
823	Yes	No	No	No ^{3,5}	Yes	<i>Acacia melanoxylon</i>		23	P	3	J10
825	Yes	No	No	No ⁵	Yes	<i>Eucalyptus sideroxylon</i>		22	F	4	I9
826	Yes	No	No	No ^{4,5}	Yes	<i>Eucalyptus sideroxylon</i>		18	F	4	I9
827	Yes	No	No	No	No	<i>Fraxinus angustifolia</i>		23	P	2	I9
828	Yes	No	No	No ^{4,5}	Yes	<i>Acacia implexa</i>		19	F/P	3	I9
829	Yes	No	No	No ^{4,5}	Yes	<i>Acacia melanoxylon</i>		17	P	2	I9
830	Yes	No	No	No	No	<i>Grevillea robusta</i>		18	G	4	I9
831	Yes	No	No	No	No	<i>Grevillea robusta</i>		14	P	3	I10
832	No	Yes	Yes	No	No	<i>Ulmus procera</i>	5	68	P	3	F10
833	No	Yes	Yes	No	No	<i>Ficus macrophylla</i>	4	46	F	6	G10
834	Yes	No	No	No	No	<i>Fraxinus angustifolia</i>		16	F/P		I8
835	Yes	No	No	No ^{4,5,8}	Yes	<i>Acacia melanoxylon</i>					H8
837	Yes	No	No	No ⁵	Yes	<i>Allocasuarina littoralis</i>		20	G	5	H9
838	Yes	No	No	No	No	<i>Angophora costata</i>		19	F	4	H9
840	Yes	No	No	No	No	<i>Agonis flexuosa</i>		38	P	2	F10
841	Yes	No	No	No	No	<i>Betula pendula</i>		12	P	2	F9
850	Yes	No	No	No	No	<i>Colonaestol glaucophyllus</i>		30	F	3	H7
851	Yes	No	No	No ⁵	Yes	<i>Melaleuca armillaris</i>		38	P	2	H7
852	Yes	No	No	No ⁵	Yes	<i>Melaleuca armillaris</i>		35	P	2	H7
853	Yes	No	No	No	No	<i>Acer negundo</i>		Dead			H7/8
1089	No	No	No	No	No	<i>Grevillea robusta</i>	4	42	F	4	D10
1163	No	Yes	Yes	No	No	<i>Ficus macrophylla</i>	5.5	64	F	5	D10
1164	No	Yes	Yes	No	No	<i>Quercus canariensis</i>	7.5	80	G	8	D10/11
1165	No	Yes	Yes	No	No	<i>Quercus canariensis</i>	6				D10/11
1166	No	Yes	Yes	No	No	<i>Ulmus procera</i>	5				D10
1168	No	Yes	Yes	No	No	<i>Ficus macrophylla</i>	3	45	F	5	D10
1169	No	Yes	Yes	No	No	<i>Ulmus procera</i>	4.5	58	F/P	4	E10
1170	No	Yes	Yes	No	No	<i>Ficus macrophylla</i>	5				D10
1171	No	Yes	Yes	No	No	<i>Ulmus procera</i>	6	68	F/G	7	E10
1172	No	Yes	Yes	No	No	<i>Quercus canariensis</i>	7	83	F/G	8	E11
1173	No	Yes	Yes	No	No	<i>Quercus canariensis</i>	6	72	G	8	E11
1174	No	Yes	Yes	No	No	<i>Ulmus procera</i>	6	66	F	7	E10
1175	No	Yes	Yes	No	No	<i>Quercus canariensis</i>	5	63	P	2	E11
1176	No	Yes	Yes	No	No	<i>Quercus canariensis</i>	6	71	G	2	E11
1177	No	Yes	Yes	No	No	<i>Ulmus procera</i>	6	75	F		E10
1178	Yes	Yes	Yes	No	No	<i>Ficus macrophylla</i>		37	F	5	E10
1179	Yes	Yes	Yes	No	No	<i>Cupressus torulosa</i>		43	P	3	E10

Comment:

Permit required to remove under Heritage Act only.

Permit required to remove under VPO2 and Heritage Act. These trees are the subject of Planning Permit Application 20070638

1 Refer Stage 2 Tree Identification Plan.

2 A tree with a score of 1 has the lowest worthiness of retention while a tree with a score of 10 has the highest worthiness of retention.

3 Exempt from permit requirement under Clause 52.17-6 as tree within 10 metres of a building.

4 Exempt from permit requirement under Clause 52.17-6 as tree forms part of the minimum extent of native vegetation necessary for the construction, use and maintenance of a dwelling and buildings and works ancillary to a

5 Exempt from permit requirement under Clause 52.17-6 as tree has been planted for "street trees, gardens, horticultural purposes or the like".

6 Exempt from permit requirement under Clause 52.17-6 as tree is dead.

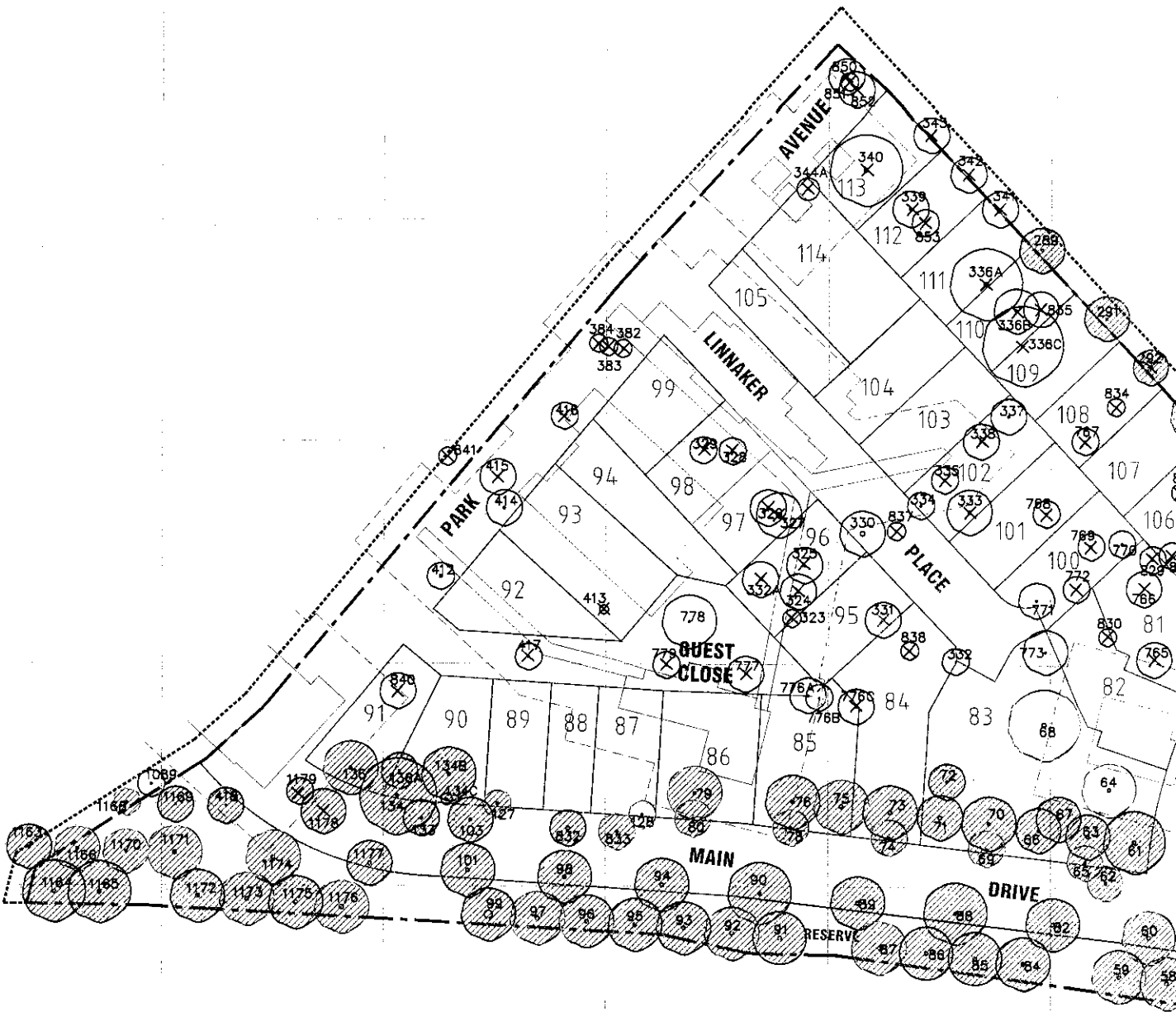

Client
Walker Corporation Pty Ltd

Project
Main Drive, Kew Stage 2 Tree Identification

Legend

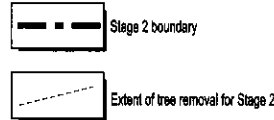
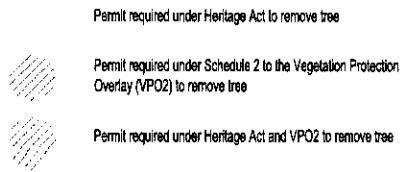
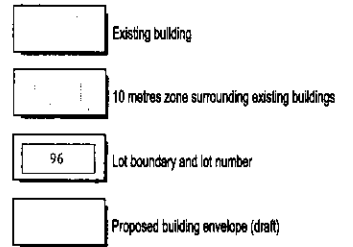
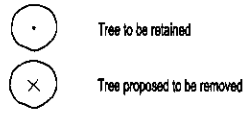
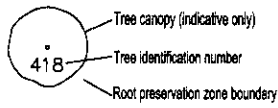

Notes:

1. Refer to Stage 2 Tree Identification Table for tree details.
2. Tree details provided by Galbraith and Associates.
3. Many of the trees are exempt (under Clause 52.17-6) from the need for a planning permit to remove (refer further Stage 2 Tree Identification Table).
4. The proposed building envelope shown on each lot is a draft only. The final building envelope will be included in Building Envelope Plan 2 to be endorsed by the responsible authority.

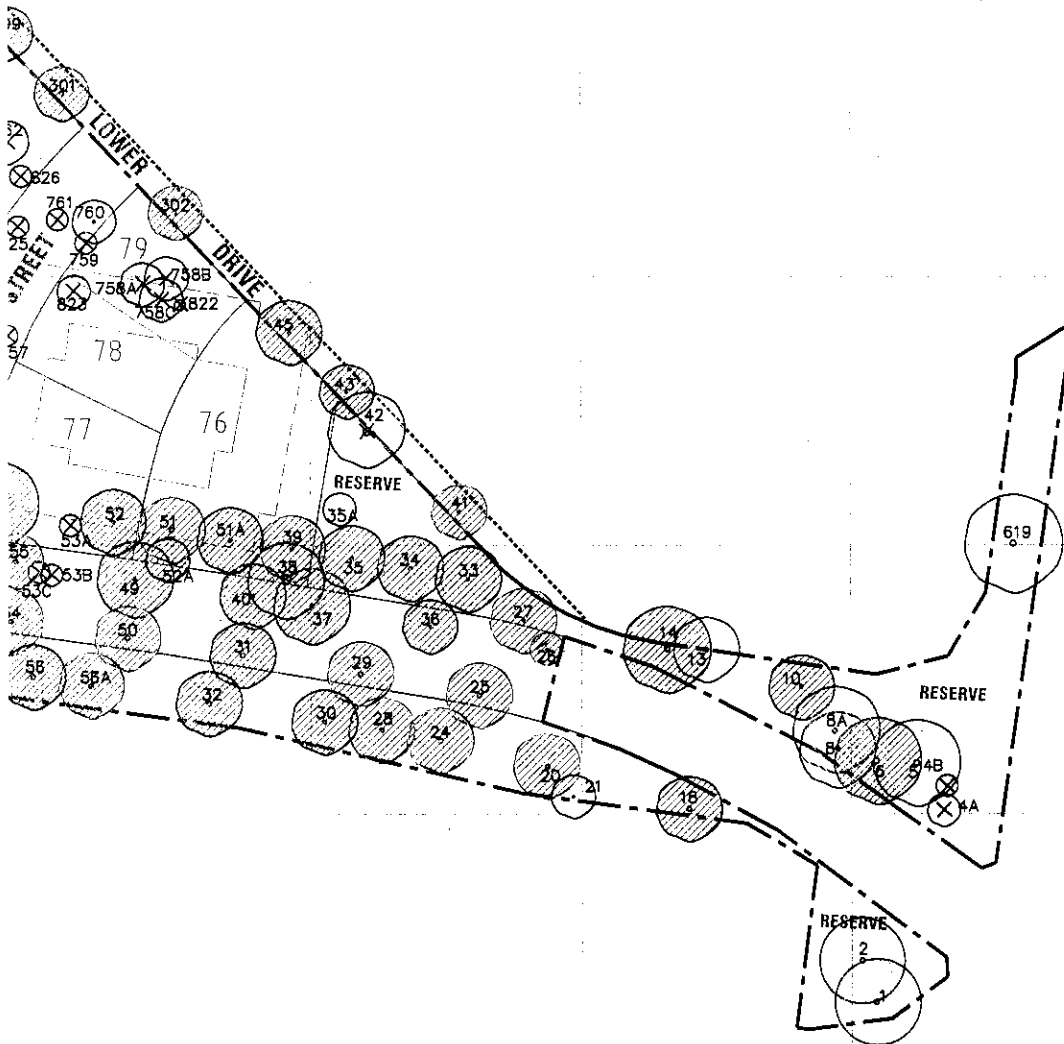

LOT 105
 Building Envelope
 from Linnaea Place
 to be a minimum of 2

PLANNING and ENVIRONMENT ACT 1987
 BOROONDARA PLANNING SCHEME
 PERMIT No. 20070638
 ENDORSED PLAN
 Sheet 1 of 1
 Signed [Signature]
 MINISTER FOR PLANNING
 Date 11 APR 2008

Drawing Number
04-6099-010-Sk006

Date of First Issue
 11.03.08

Drawn
 CEL
 Scale
 at A2
 1:1000



LEGEND



Stage 2 Boundary

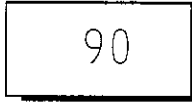

Lot Number

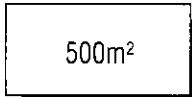

Lot Area

ROAD CATEGORIES

Access Street (R 15 metres : P 5.8 metres)

Road Type

Reservation
Width

Pavement
Width

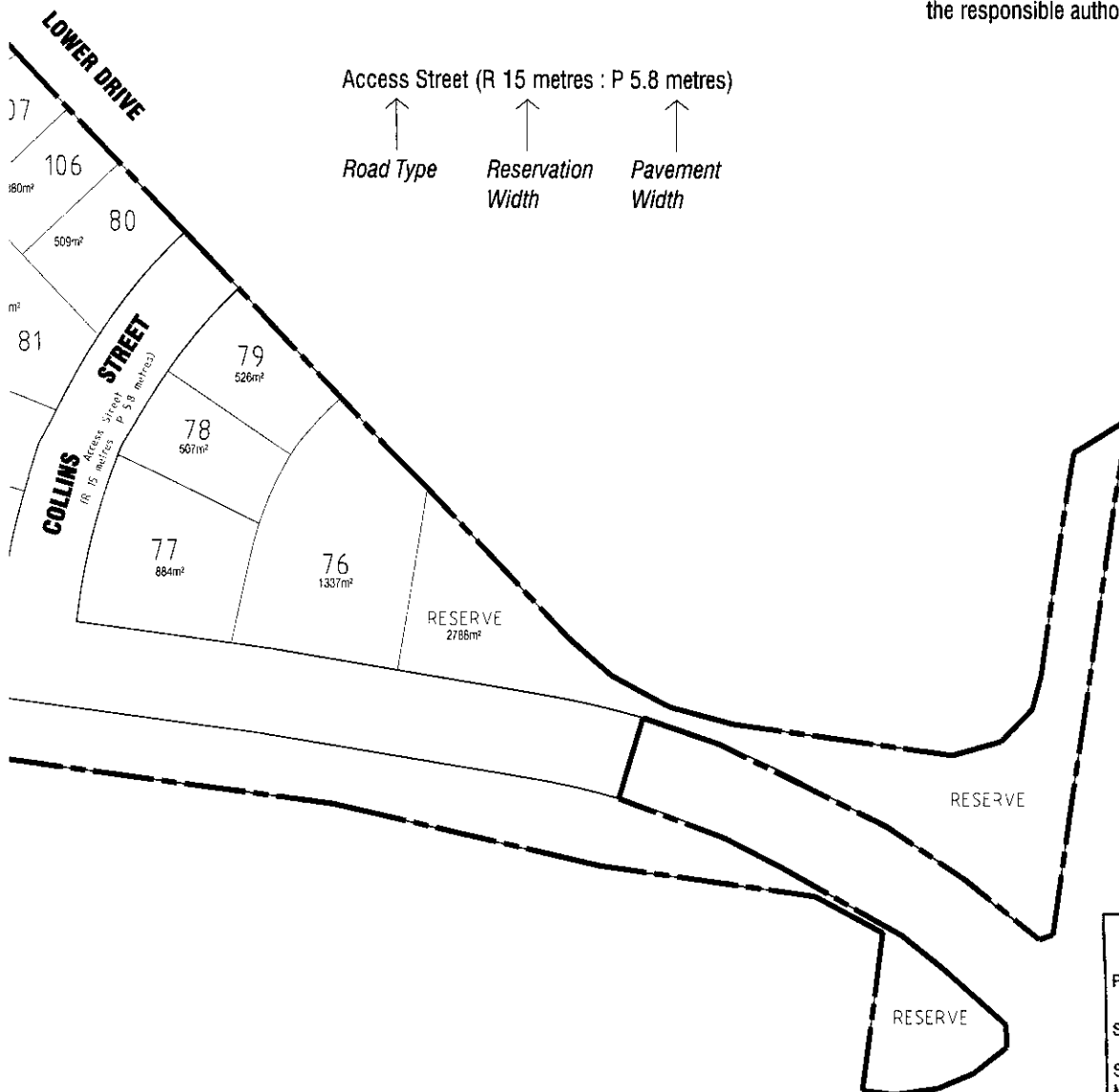

NOTES

- Pavement width generally measured back of kerb to back of kerb. Park Avenue includes localised pavement narrowings to 5.8 metres to allow for indented carparking.
- Areas and dimensions may vary in plans of subdivision based on final survey work associated with each subdivision stage. The plans of subdivision will be submitted for certification.
- The footpaths, courthead and road pavement treatments are not shown. Detailed design of roads, driveways and footpaths is provided in the construction plans to be submitted for endorsement. These details will also be included in Building Envelope Plan 2 to be endorsed by the responsible authority.

PLANNING and ENVIRONMENT ACT 1987	
BOROONDARA PLANNING SCHEME	
PERMIT No.	2007 0638
ENDORSED PLAN	
Sheet	of
Signed	for
MINISTER FOR PLANNING	
Date	11 APR 2008

Drawing Number

Date of First Issue

Drawn

Scale
at A2

04-6099-010-1000 TP02

11.03.08

CEL

1:1000



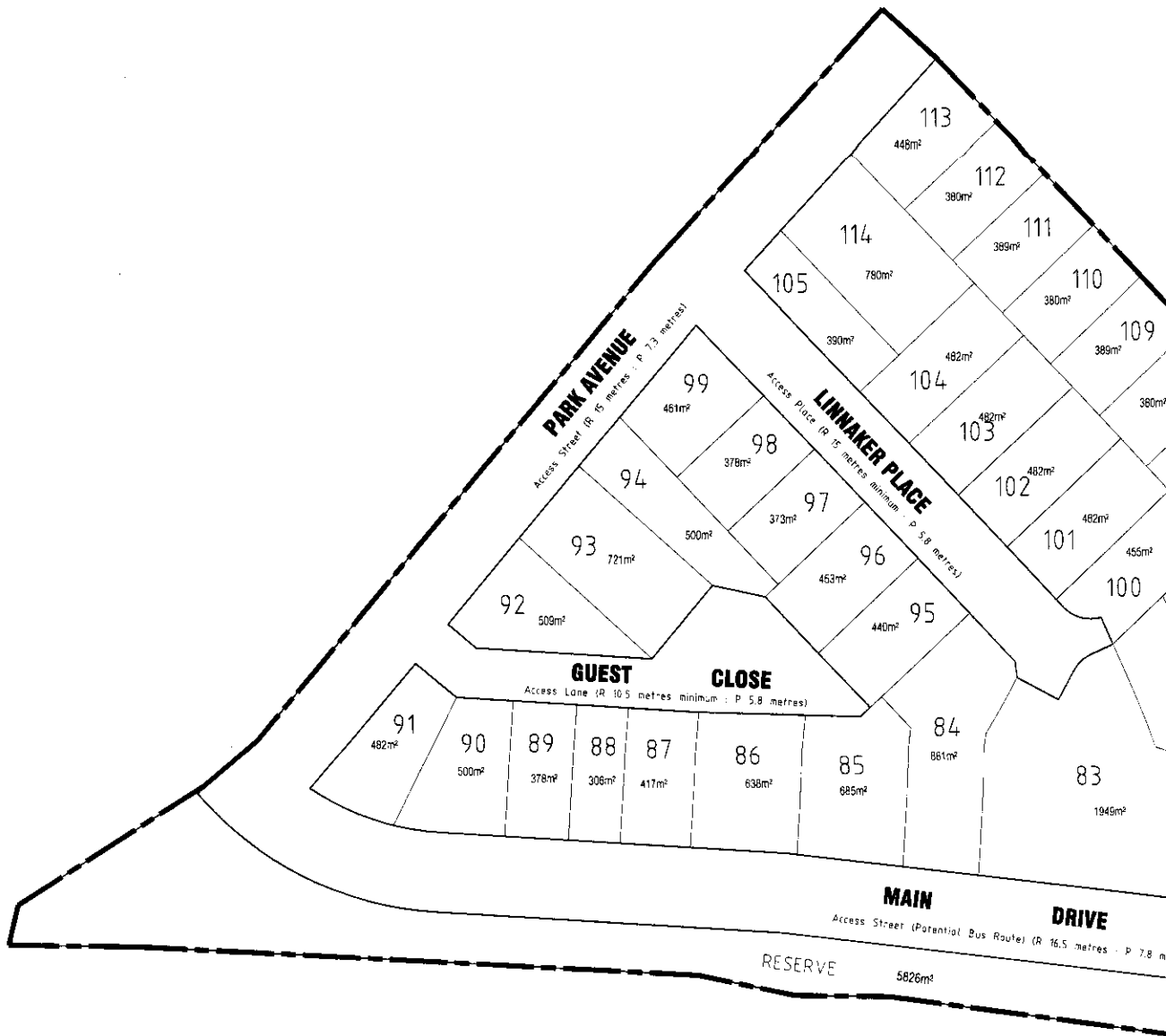

Client
Walker Corporation Pty Ltd

Project
Main Drive, Kew

Drawing
Stage 2 Subdivision Plan TP02